

## DOUBLE TRIANGLE CAVITY WALL TIE DT200/ DT225/ DT250/ DT300

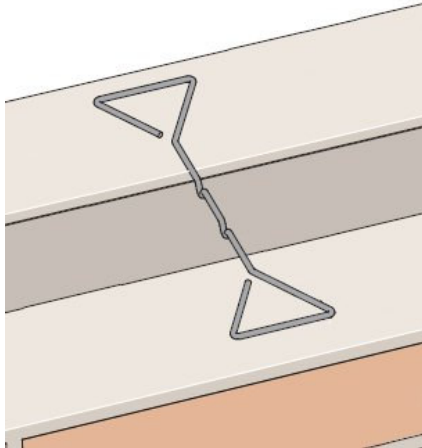

Cavity (mm)	Reference	Tie length (mm)
75	DT200	200
100	DT225	225
125	DT250	250
150	DT300	300

1.4301 Austenitic Stainless Steel to BS EN 10088-3 : 2005.

Supplied in boxes of 250

Insulation clip SSCD is also available

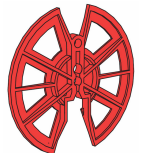

### Standards and Conformity

BS EN 845-1 Specification For Ancillary Components in Masonry - Part 1 :Ties, tension straps, hangers and brackets.

Declared Loads over a 100mm cavity

Declared Loads over 150mm cavity

Test	Declared value (N)
Tension	2154
Compression	1402

Test	Declared value (N)
Tension	2093
Compression	906

BS 5628-1 Code of practice for the use of masonry - Part 1: Structural use of unreinforced masonry.

DT200 and DT225 Type 2 tie

DT250 and DT300 Type 3 tie

Approved Document E: Resistance to the passage of sound

Tie type B

### Features

Safety ends reduce the risk of injury during handling and installation.

Light weight making installation quick, easy and economical.

### Installation

Code of practice BS 5628-1 states that walls that have leaves 90mm or thicker should include wall ties at not less than 2.5 ties per m<sup>2</sup>. Stagger wall ties in alternate courses at 900mm horizontal and 450mm vertical spacings. Wall ties adjacent to openings in masonry panels, vertical movement joint locations or non returned edges should be positioned at a maximum 300mm vertical spacing and no more than 225mm away from the opening. The DT tie must be bedded into fresh mortar at the time of the wall construction ensuring nominal 62.5mm embedment in each leaf. The cavity spanning section of the tie is to be kept free of mortar.

### Accessories

The DT Wall Tie can be used in conjunction with the Expamet Building Products SSCD insulation retaining clip.



# DOUBLE TRIANGLE CAVITY WALL TIE DT200/ DT225/ DT250/ DT275/ DT300

## Contact information

Technical:  
Telephone 01429 866655  
Email [technical@expamet.net](mailto:technical@expamet.net)  
Fax 01429 866622

Sales:  
Telephone 01429 866611  
E-mail [sales@expamet.net](mailto:sales@expamet.net)  
Fax 01429 866622

## Expamet Health and Safety

### 1. IDENTIFICATION

Expamet Building Products Limited  
Greatham Street  
Longhill Industrial Estate (North)  
Hartlepool TS25 1PR  
United Kingdom  
Tel: +44 (0)1429 866688  
Fax: +44 (0)1429 866633

### 2. COMPOSITION

Stainless steel 1.4301 to BS EN 10088-3: 2005

### 3. HAZARDS IDENTIFICATION

Possible cuts from steel edges.  
Toxic and irritant fumes from high temperatures.

### 4. FIRST AID MEASURES

Skin and eye contact: treat cuts from steel edges as required.  
Ingestion: not applicable.  
Inhalation: remove from source of fumes and dust.

### 5. FIRE FIGHTING MEASURES

Non-flammable material.

### 6. ACCIDENTAL RELEASE MEASURES

Not applicable.

### 7. HANDLING AND STORAGE

Use suitable PPE when handling all products. Assess manual handling risks before lifting. All products should be stacked on firm level ground in dry conditions.

### 8. EXPOSURE CONTROLS

Wear personal protection such as gloves and safety goggles when handling products.  
Some products may have a film of soluble cutting fluid after manufacture; therefore carry out personal hygiene, including proper washing of hands, after contact.

Expamet operates a continuous development programme and we reserve the right to amend specification with prior notification

Expamet Building Products Limited, Greatham Street, Longhill Industrial Estate (North) Hartlepool TS25 1PR  
Telephone : 01429 866611 Fax : 01429 866622 Email : [info@expamet.net](mailto:info@expamet.net)

